

Ceramic Drinking Water Filter Candle



Preparing the Filter for use

These instructions cover a variety of filter candle grades, therefore, please ensure that you follow the relevant instructions for the grade of candle that you have purchased

Extreme cleanliness is important. Wash hands before handling the product and take care to ensure that no contamination of the components occurs during assembly

Installation

When installing a new filter candle it is important to condition the filter with the incoming water using the following procedure:

	Rated Service Flow for Optimum Performance	Filter Capacity
Super Sterasyl®	Gravity Flow	533 USG/2000 L
Ultra Sterasyl®	Gravity Flow	400 USG/1500 L
Sterasyl®	Gravity Flow	2600 USG/10,000 L
Ultra Fluoride	Gravity Flow	400 USG/1500 L

Gravity Filters

- Place the sealing washer over the threaded mount
- Place the filter candle mount stem through the hole in the upper section of the housing and secure with a wing nut. Do not over tighten
- Ensure that the outlet tap is in the off position
- Fill the upper container with cold water and allow this to filter through. Our filter is made of a special ceramic and contains carbon granules; this means black particles may be visible when water filters through for the first time. Discard the first filtered water.
- Repeat the process and run at least 1 litre of water to waste per fitted filter, and continue running until the water is clear. Wipe the lower chamber with a clean cloth to remove any dust particles - **the filter is now ready for use**

PLEASE NOTE

- Super Sterasyl®, Ultra Sterasyl® and Ultra Fluoride candles contain carbon granules and black particles may be seen in the water that first runs to waste
This is normal and will clear as the water runs
- If the filter is left to stand for more than 3 days without use, it is recommended that one litre of water be allowed to run to waste before using

Operation

Due to filtration of particulate contaminants from the water during use, the flow of water from the filter may reduce over a period of time. To restore the water flow to its normal level, remove the filter and scrub the surface evenly with a clean abrasive kitchen pad under running water or in a bowl, ensuring that the open ended plastic mount is clear of the water, to avoid contamination

Manufactured by Doulton Water Filters, Newcastle, Staffordshire, ST5 9BT, United Kingdom.

Doulton®, British Berkefeld® and Sterasyl® are trademarks registered to Fairey Industrial Ceramics Limited.

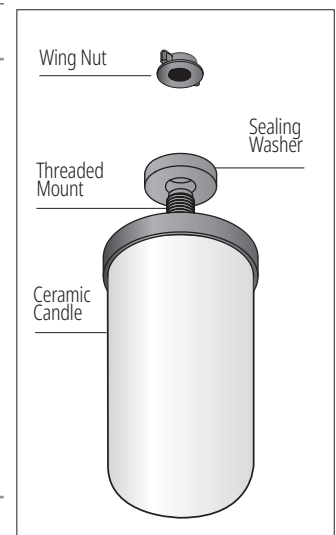

**AUTHENTICITY
GUARANTEE**

Authenticate and Register your British Berkefeld® Drinking Water Filter

The unique 10 digit authenticity code printed on your British Berkefeld® water filter enables you to authenticate and register your product directly with British Berkefeld®.

This gives you the reassurance that you have purchased a genuine British Berkefeld® product that has been precision made, in England, to the highest standards.

Authenticity and registration of your British Berkefeld® water filter can be completed online by visiting:

www.doulton.com



To ensure an accurate match with the British Berkefeld® database please, carefully, input both the Product Reference Code and the Unique Authenticity Code (indicated above) and follow the instructions on screen.

LEGAL DISCLAIMER.

In the absence of any negligence or other breach of duty by us, the installation and use of this product is entirely at your own risk. You must at all times observe and comply with our instructions (whether set out in the appliance manual or otherwise) relating to the installation and use of this product. We will not be liable nor responsible to you for any loss or damage, legal disputes or conflicts of interests and other adverse events you suffer as a result of your failure to observe or comply with our instructions or otherwise results from your misuse or irresponsible or negligent use of the product or as a result of any events outside of our control. To the maximum extent permitted by any applicable laws, we make no warranty, representation or guarantee (whether express, implied or otherwise) regarding the fitness, merchantability, or suitability of this product for any unreasonable or unforeseeable purpose. This disclaimer does not affect your statutory consumer rights or otherwise restrict or limit any liability that we cannot lawfully exclude under any applicable laws.

**A GENUINE
WATER FILTER**

**MADE IN
BRITAIN**



www.doulton.com

BRITISH BERKEFELD® GRAVITY SYSTEM ASSEMBLY INSTRUCTIONS AND OPERATION:

Carefully unpack the ceramic filters and parts, checking them against the diagram. The number of filter elements included depends on the model purchased.



Maintain extreme cleanliness when assembling. Wash your hands thoroughly before starting. Take care not to contaminate any components during assembly.

1. Attach the knob (1) to the lid (2) by inserting the screw (3) up through the lid hole and screwing the knob on top. Hand tighten only.
2. Slide the large sealing washer (10) over the threaded end of the ceramic filter (5).
3. Insert the filter (5) into the hole in the base of the upper chamber (4).
4. Secure the filter by screwing the wing nut (11) onto the threaded mount.
5. Repeat steps 2 through 4 for all remaining ceramic filters.
6. Slide the one washer (8) onto the threaded spigot (7).
7. Insert the spigot's thread through the hole in the lower chamber's (6) side.
8. Inside the chamber, add the second washer (8) over the thread and secure with the nut (9). Hand tighten only.
9. Ensure the spigot (7) is in the "OFF" position.
10. Place the upper chamber (4) onto the lower chamber (6).
11. Place the lid (2) on the upper chamber (4).

CONDITIONING THE FILTERS:

Fill the upper chamber (4) with cold water, cover with the lid (2), and let the water gravity filter into the lower chamber. Open the spigot to drain all water. Allow filters to stand unused overnight. Refill upper chamber with water, filter for one hour, then open spigot for two minutes to flush water. The British Berkefeld® filter is now ready for use.

Note: A new ceramic filter may filter slowly at first but will increase flow rate after several refills as it conditions with use.

If filters are left unused for over 3 days, run water through for 1 minute before drinking. When installing a new ceramic filter, follow the conditioning procedure above. Replace filters every 6 months for optimum water quality. Cleaning instructions are included with each new filter.

DISINFECTING THE LOWER CHAMBER, SPIGOT, AND FILTERS:

Remove upper chamber (4) and drain any water. With the ceramic filters remaining installed in the upper chamber (4), place upper chamber (4) upside down to ensure it will not roll off your counter or other work surface. Clean lower chamber (6) with mild dish soap or a 1:1 mixture of water and vinegar, and rinse thoroughly. Remove spigot (7) and soak it in a 1:1 mixture of clean water and vinegar for 5-10 minutes to help remove any mineral deposits. Rinse spigot thoroughly. Reattach spigot (7). Carefully place upper chamber (4) onto lower chamber (6). Refill the upper chamber (4) and filter all water. Flush the filtered water through the spigot (7) for a few minutes then discard. Perform this disinfection procedure periodically or if contamination is suspected.

IF A FILTER IS ACCIDENTALLY DROPPED:

Air dry the filter for at least 24 hours. Submerge it in water while blocking the outlet to trap air inside. If cracks are present, the trapped air will bubble out indicating the candle needs replacement.

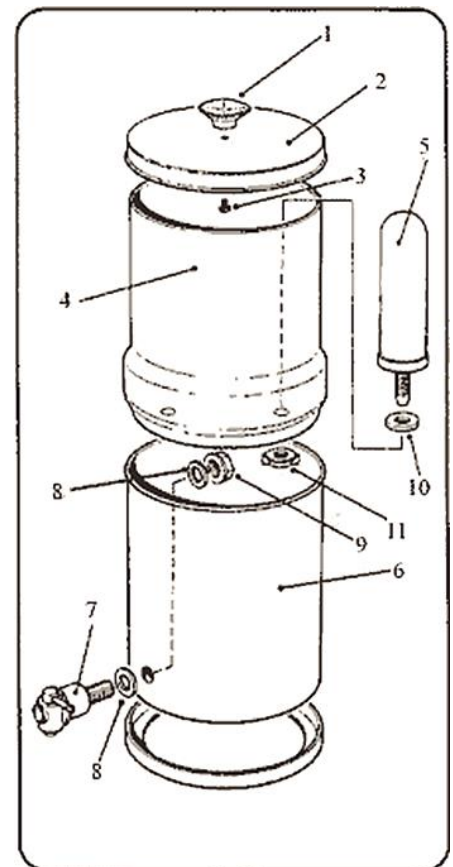

Sold by: British Water Filter. Toll free (800) 244-9864

Email: customerservice@britishwaterfilter.com ▪ www.britishwaterfilter.com